

Section-AA
Scale 1:20

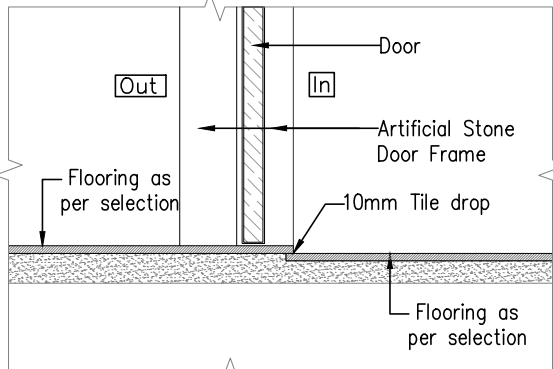

Detail_A
Scale 1:10

Legends for hatch	
	Proposed Wall Masonry
	Proposed RCC Structure

Legend for Flooring		
(A)		Vitrified Tile (600x600)
(B)		Vitrified Tile (600x600)
(C)		Granite Stone
(D)		Kota Stone
(E)		Heat Resistance Tile (300x300)
Matt Finish Vitrified Tile		

Rev	Date	Issued	Issued to	Tender	KBP
01	08-03-25	SC & PR	GMDC		

Key Plan:

Project: SKVM

Drawing: Flooring Layout
C Type Quaters
Sheet 01

Drawing Code: 2331_ARC_TD_25_R0

Print Size: A3 Scale: As Mentioned

File Title: 2331_ARC_TD_25_R0

Project Code: MSA 2331	Project Type: ARC & INT	Location: Mandvi
Print Date: 7-Mar-25	Drawn By: K Patel	Checked By: K Patel
		Approved By: M Shah

MAMTA SHAH & ASSOCIATES
Architects & Interior Designers
C-12, Chanakyapuri Society,
Chanakyapuri Char Rasta,
New Sana Road, Baroda
Ph. No. +91 965 2715267 / 2710967
mamta@msain.com / www.msain.com

Client: Gujarat Mineral Development Corporation
GMDC
FUELING THE GROWTH