

LAST SAVED BY: iparikh 7/6/25 5:03 PM

This drawing is property of Mamta Shah & Associates. Without our prior consent, it must be neither copied nor made available to third parties for the purpose other than for which it is meant.

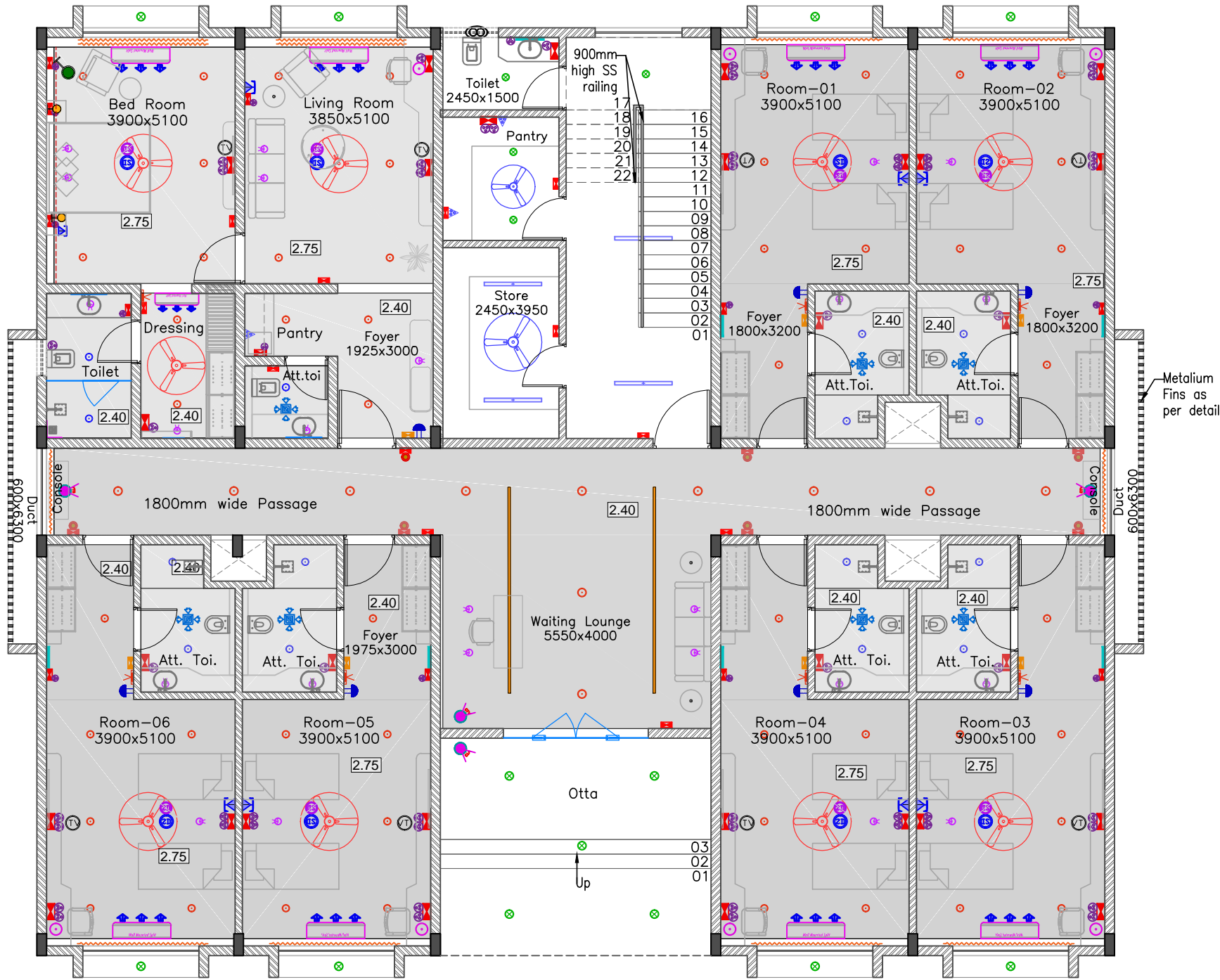

Legends for hatch	
	Proposed Wall Masonry
	Proposed RCC Structure

R1	07-06-25	Softcopy	Contractor	Tender	KAP
R0	08-03-25	Softcopy	Contractor	Tender	KAP
Rev	Date	Issued	Issued to	Issued for	Author

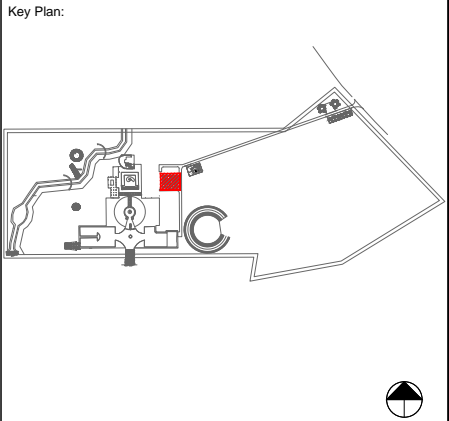

Note :- External lighting wire from Main electrical distribution Panel.
All ODU Located at terrace Level.
VRF System in consider

Ceiling material Legend	
Hatch	Material finish
	Gypsum ceiling
	Curtain

Lighting fixture Legend		
BOQ Item	Symbol	Description
		Surfaed 28-33Watt Batten Lighting 1.2m
		9-15W Fabic Floor Lamp Light
		Decorative Hanging Light
		15-20 Watt Recessed mounted Led down lighter
		5-8W Wall Mirror Light
		Indoor cove mounted customized 18X18mm corner 45degree
		Continuous Led profile light

Lighting fixture Legend		
BOQ Item	Symbol	Description
		12-15 Watt Recessed mounted Led down lighter
		12-15 Watt Surface Mounted COB Type Cylinder Light
		Circle Wall washer light-adjustable
		Led Flood light
		Wall Mounted Led Bracket light
		9-15W Decorative Fabic Wall lamp light
		Buzzer

ELV Legend	
Symbol	Fixture
	Speaker
	Below Smoke Detector
	Above Ceiling Smoke Detector
	WIFI
	CCTV

HVAC Legend	
Symbol	Description
	Mechanical Ventilation Exhaust
	Wall Mounted Split AC

Legend for Electrical		
Symbol	Wall mounted lighting	Height SB
	Main Switch board	1200
	Key Card Switch	1200
	6 - AMP Plug point	As per detail
	16 - AMP Plug point	
	6 AMP Plug point with switch	
	16 AMP Plug point with switch	
	Intercom Telephone	
	Exhaust Fan	
	TV Cable = 2 nos.-5 amp plug point	As per Detail
Note:- Consider All Switch board height from Bottom.		

Project:

SKVM

Drawing:

RCP Layout _ Ground Floor Plan
Hostel Building
Sheet 01

Drawing Code:

2331_INT_TD_HOS_FLC_R1

Print Size:

A3

Scale:

1:100

File Title:

2331_INT_TD_HOS_FLC_R1

Project Code:

MSA 2331

Project Type:

ARC & INT

Location:

Mandvi

Print Date:

7-Jun-25

Drawn By:

K Parikh

Checked By:

K Patel

Approved By:

M Shah

MAMTA SHAH & ASSOCIATES
Architects & Interior Designers
C-12, Chanakyapuri Society,
Chanakyapuri Char Rasta,
New Santa Road, Baroda
Ph. No. +91 365 2715267 / 2710967
mamta@msain.com / www.msain.com

Client:

Gujarat Mineral Development Corporation